

REVISIONS				
REV.	DESCRIPTION	ECO #	DATE	APPROVED
B1	RELEASE	2019-054	5/17/2019	

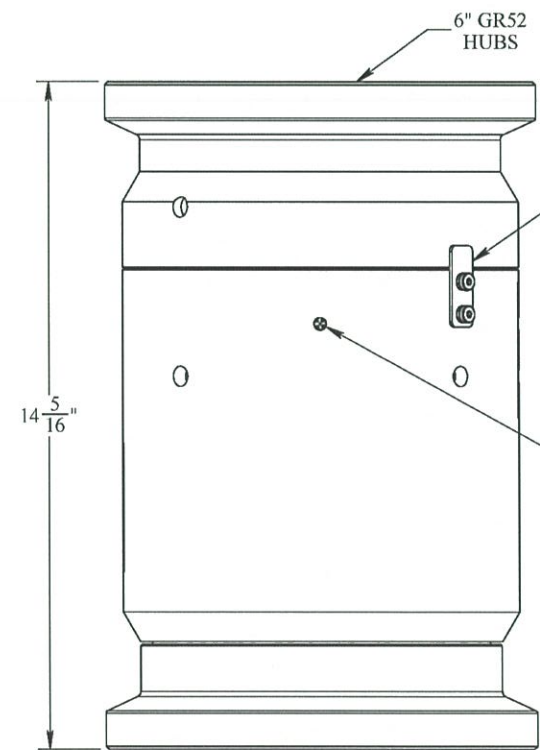

ANTI-ROTATIONAL TAB
CHECK VALVE

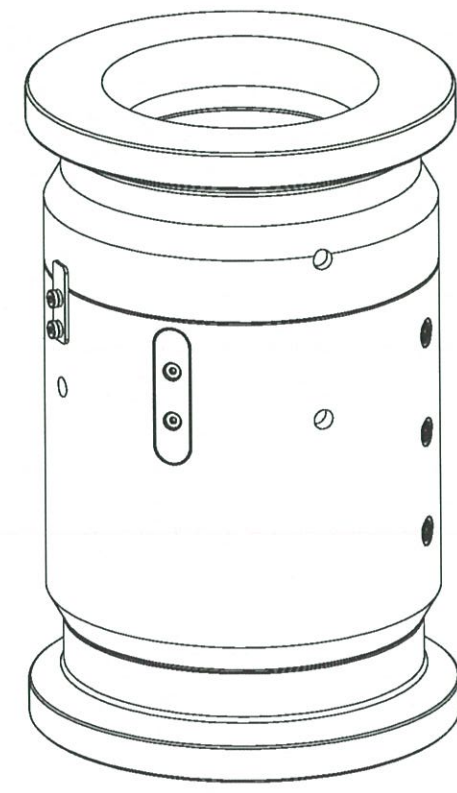
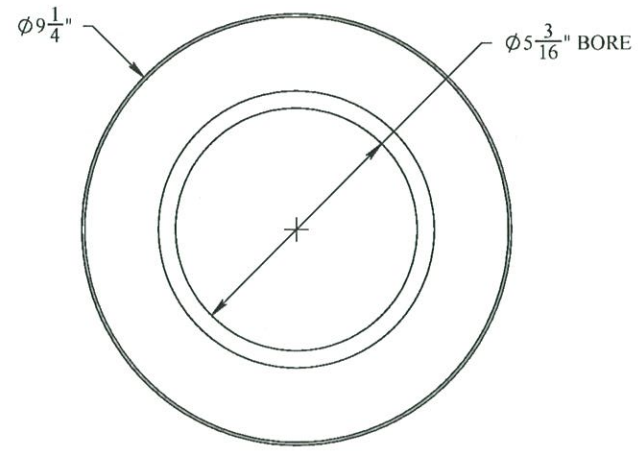
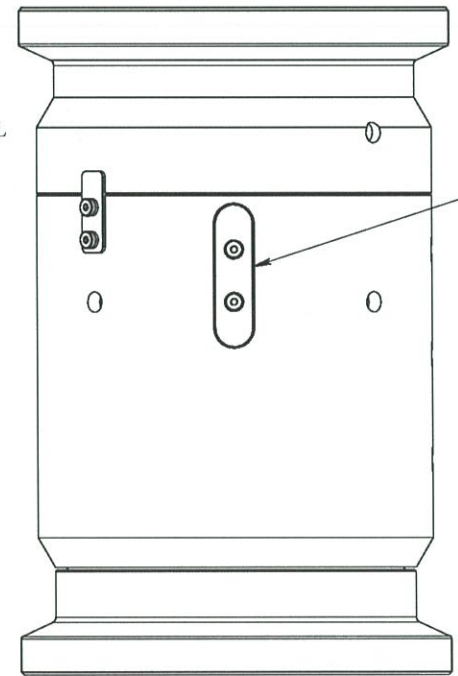

BALL BEARING KEEPERS

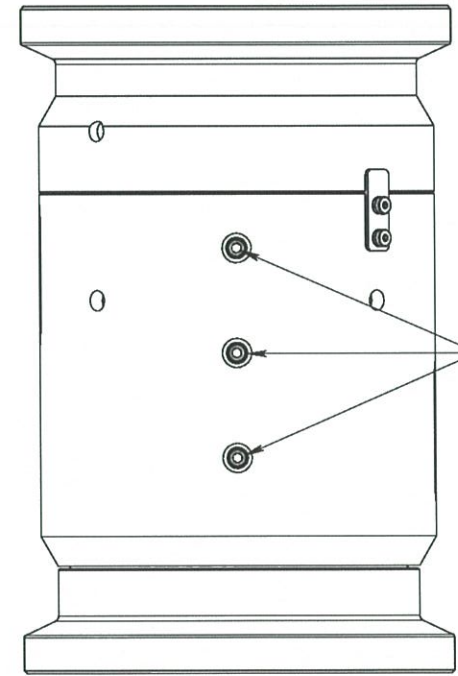

GREASE PORTS

NOTES:

1. DESIGNED FOR DRILLING MUD LINES
2. WORKING PRESSURE - 2K PSI
3. TESTED AT 1.5 TIMES THE WORKING PREWSSURE
4. 6" GR52 HUBS ON BOTH ENDS
5. MATERIAL OF CONSTRUCTION: NITRONIC 50 / 17-4 PH
6. REMOVABLE PLUGS TO ACCESS 3 GREASE PORTS

SPECIFICATIONS:

7. MAX ROTATIONAL TORQUE: @ 0 PSI IS 500 LB. FT. / @ MWP IS 2,500 LB. FT.
8. MAX AXIAL LOAD: 16,750 KG
9. MAX BENDING MOMENT: @ MWP 18 KNM
10. SUITABLE FOR 50 METERS SUBSEA
11. DESIGNED TO API 6A, 16D, AND 17D
12. MEETS NACE MR-0175

PROPRIETARY AND CONFIDENTIAL:
THE INFORMATION CONTAINED IN THIS DRAWING IS THE SOLE PROPERTY OF THE SUBSEA COMPANY INC. ANY REPRODUCTION IN PART OR AS A WHOLE WITHOUT THE WRITTEN PERMISSION OF THE SUBSEA COMPANY INC IS PROHIBITED.

3RD ANGLE PROJECTION:

INTERPRET GEOMETRIC TOLERANCING PER: ASME Y14.5

WORKMANSHIP STANDARD PER WI 751-001

UNLESS OTHERWISE SPECIFIED:
ALL DIMENSIONS ARE IN INCHES

WEIGHT: 125.30 LBS.

	NAME	DATE
DRAWN	CREA	5-21-19
CHECKED		5-20-19
APPROVED		5-20-19

		THE SUBSEA COMPANY INC	
		SIZE: B	TITLE: SWIVEL, LC, 6" 6GR52 HUBS, 2K MWP
DWG. NO. TSC-02422-GA		REV: B1	SHEET 1 OF 1