

REVISIONS				
REV.	DESCRIPTION	ECO #	DATE	APPROVED
A1	RELEASE	2013-088	2/18/2013	GNB
A2	SHOW MACHINED CLAMP HALVES	2013-234	4/24/13	GNB

ITEM NO.	PART NUMBER	DESCRIPTION	QTY.
10	TSC-01000	1-1/2" MUX CLAMP CABLE RETAINER ASSEMBLY	1
20	TSC-00999	MUX RETAINER CABLE ASSEMBLY	1
30	TSC-01002	PIPE CLAMP, MUX CLAMP CABLE RETAINER	1

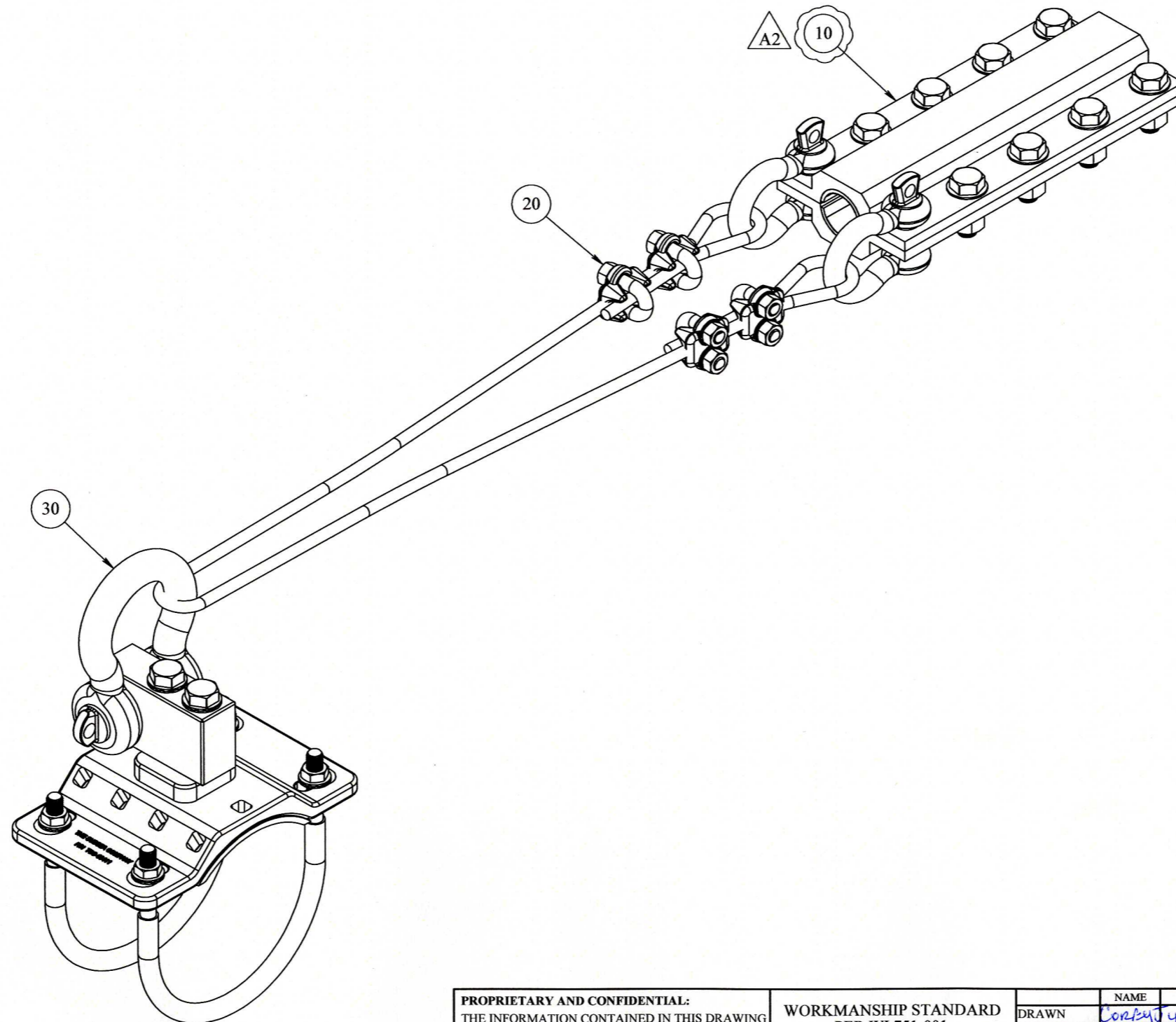

<b>PROPRIETARY AND CONFIDENTIAL:</b> THE INFORMATION CONTAINED IN THIS DRAWING IS THE SOLE PROPERTY OF THE SUBSEA COMPANY INC. ANY REPRODUCTION IN PART OR AS A WHOLE WITHOUT THE WRITTEN PERMISSION OF THE SUBSEA COMPANY INC IS PROHIBITED.	<b>WORKMANSHIP STANDARD</b> PER WI 751-001	<table border="1"> <tr> <th>NAME</th> <th>DATE</th> </tr> <tr> <td>CONLEY</td> <td>4-24-13</td> </tr> <tr> <td>GREG</td> <td>4-24-13</td> </tr> <tr> <td>CATER</td> <td>4-24-13</td> </tr> <tr> <td>ROBERT</td> <td>4-24-13</td> </tr> </table>	NAME	DATE	CONLEY	4-24-13	GREG	4-24-13	CATER	4-24-13	ROBERT	4-24-13	<b>THE SUBSEA COMPANY INC</b>
	NAME	DATE											
	CONLEY	4-24-13											
GREG	4-24-13												
CATER	4-24-13												
ROBERT	4-24-13												
UNLESS OTHERWISE SPECIFIED: ALL DIMENSIONS ARE IN INCHES	SCALE: 1:16	SIZE: <b>B</b>	TITLE: MUX CABLE RETAINER										
3RD ANGLE PROJECTION:	WEIGHT: 51.54 lbs.	DO NOT SCALE DRAWING	DWG. NO. TSC-00983										
INTERPRET GEOMETRIC TOLERANCING PER: ASME Y14.5			REV <b>A2</b>										
			SHEET 1 OF 1										