

REVISIONS				
REV.	DESCRIPTION	ECO #	DATE	APPROVED
A2	UPDATE RENDERING	2015-157	9/1/2015	CMB

ACCESSORIES		
PART NO.	DESCRIPTION	QUANTITY
SE-1112	GREASE, SYNTHETIC, INDUSTRIAL, LC 2, NLGI GRADE 1.5	14 oz
SE-0019	RING GASKET, 3 1/16", BX154	2

TSC-00468-SK SEAL KIT, SWIVEL, 15K, CHOKE AND KILL		
PART NO.	DESCRIPTION	QUANTITY
SE-0752-1	POLYPAK, TYPE B, 5" ID x 6" OD x .825" TALL, POLYMITTE, BLACK	2
SE-0748-1	POLYPAK, STANDARD, 5" ID x 6" OD x .550" TALL, POLYMITTE, ORANGE	1
SE-0545-1	O-RING, 2-449	1
SE-0757	SEAL, RADIAL SHAFT, 8-1/2" SHAFT	1
SE-0846	SEAL, RADIAL SHAFT, 6-1/2" SHAFT	1

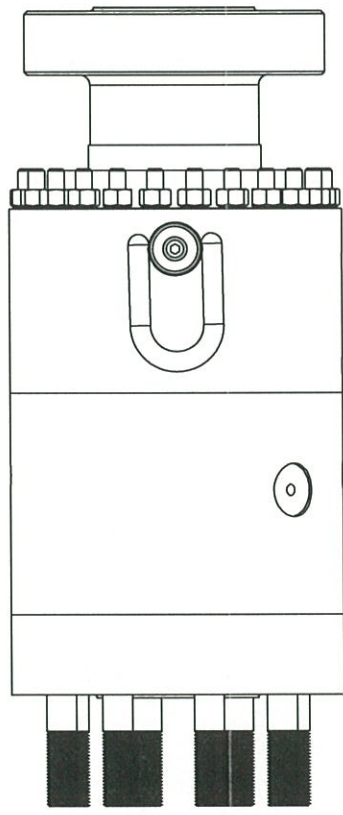
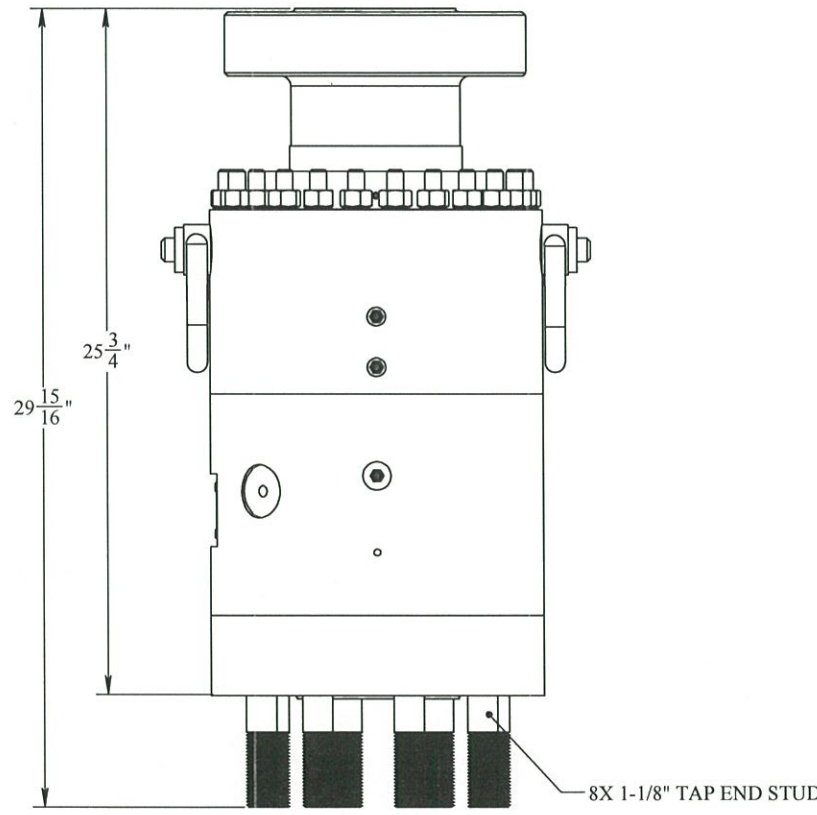
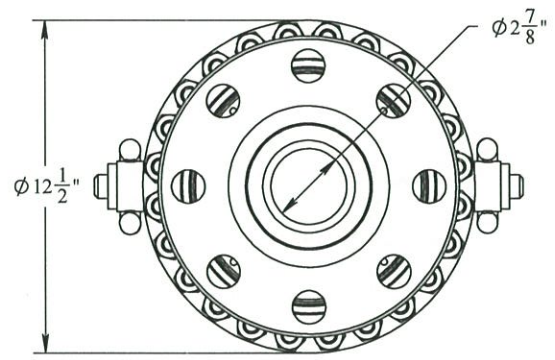

- NOTES:
- MATERIAL OF CONSTRUCTION:
- BODY CONSTRUCTED OF 4130 STEEL
- HARDWARE: A193 B7 & A453 GRADE 660 CLASS D
 - DESIGNED FOR CHOKE & KILL LINES
 - WORKING PRESSURE - 15K PSI
 - TESTED AT 1.5 TIMES WORKING PRESSURE
 - 3-1/16" API FLANGE - BX-154 RING GROOVE, BOLTED CONNECTION ON ONE END AND STUD CONNECTION ON THE OTHER
 - THREE ZERK FITTINGS AND BLEED PORTS FOR GREASING INTERNAL BEARINGS
 - TWO REMOVABLE LIFTING RINGS FOR RIGGING SWIVEL RATED FOR A COMBINED 2,000 LBS MAX. LIFTING CAPACITY AT 90 DEGREES
WEIGHT: 684 LBS.
 - STANDARDS AND REGULATIONS
 - DESIGNED TO API 16C AND API 6A SPECS.
 - MEETS NACE MR 0175

PROPRIETARY
THE INFORMATION CONTAINED IN THIS DRAWING IS THE SOLE PROPERTY OF THE SUBSEA COMPANY INC.

3RD ANGLE PROJECTION:

INTERPRET GEOMETRIC TOLERANCING PER: ASME Y14.5

WORKMANSHIP STANDARD PER WI 751-001

UNLESS OTHERWISE SPECIFIED:
ALL DIMENSIONS ARE IN INCHES

WEIGHT: 683.54 lbs.

	NAME	DATE
DRAWN	GREG	9-1-15
CHECKED	Greg	9-1-15
Q.A.	RW	9-1-15
MFG./SALES	RW	9-2-15

		THE SUBSEA COMPANY INC	
		SIZE: B	TITLE: SWIVEL, CHOKE AND KILL, 3-1/16", 15K, API 16C DESIGN
DWG. NO. TSC-00468-GA-SALES			SHEET 1 OF 1